

TRECHO 1
Escala 1:500

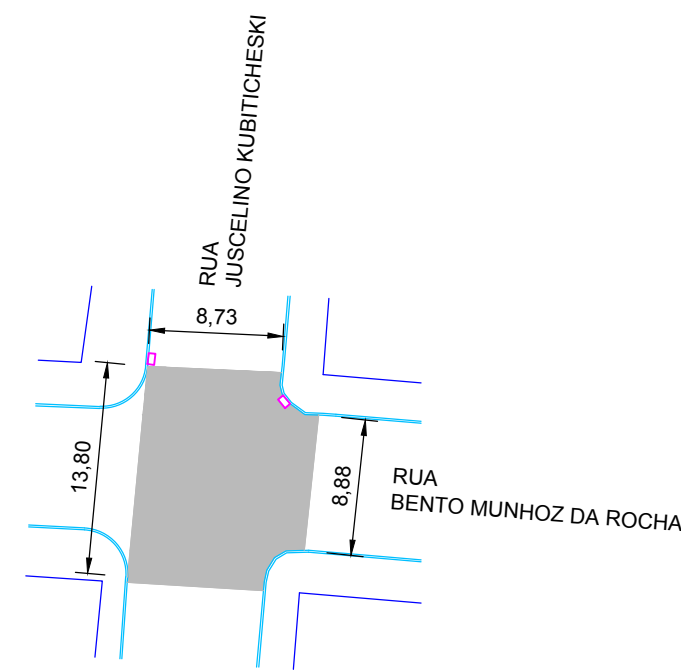

CRUZAMENTO 1
Escala 1:500

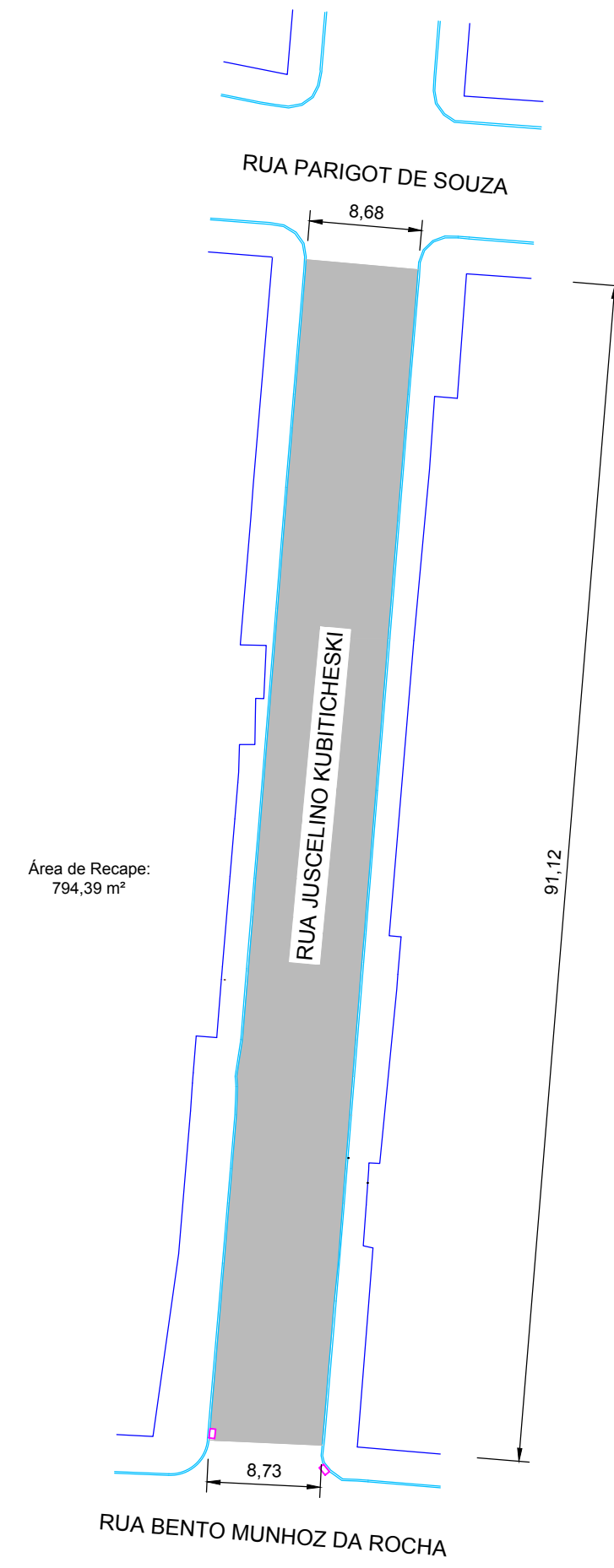

TRECHO 2
Escala 1:500

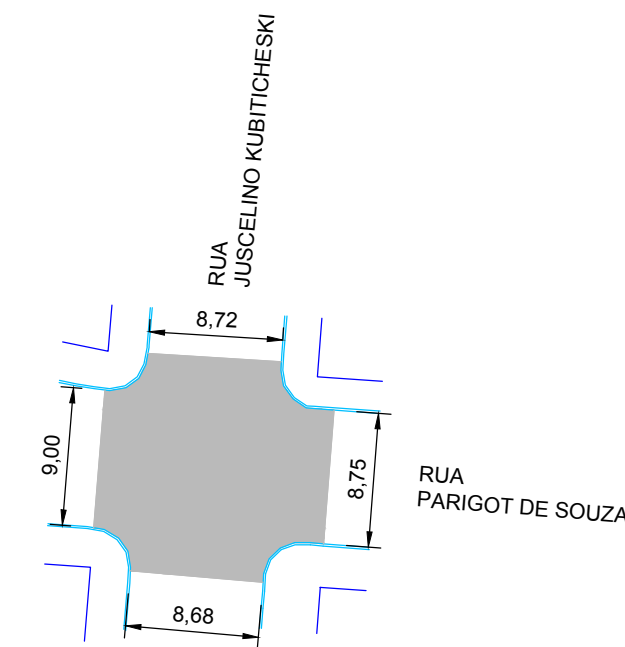

CRUZAMENTO 2
Escala 1:500

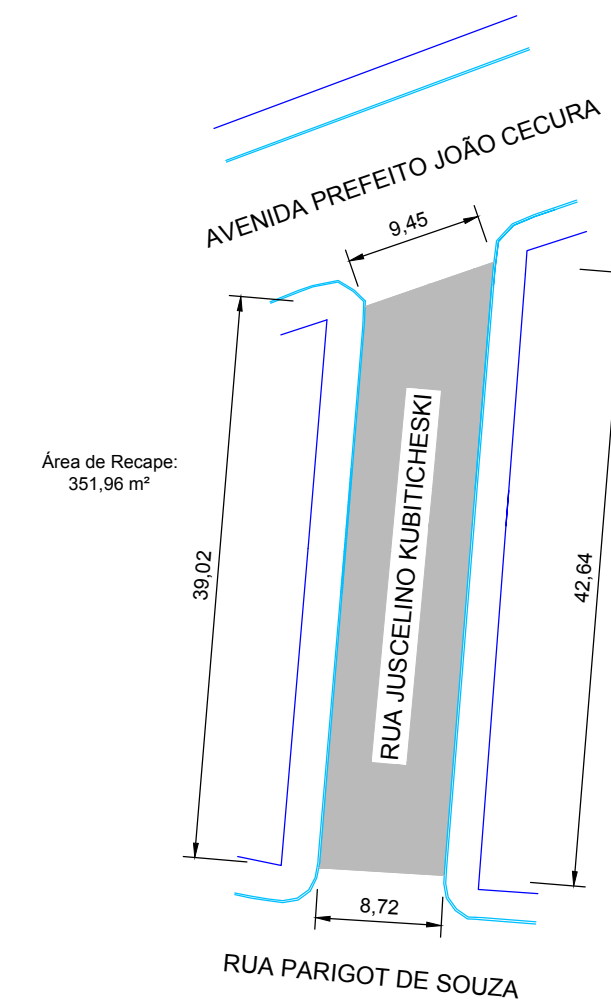

TRECHO 3
Escala 1:500

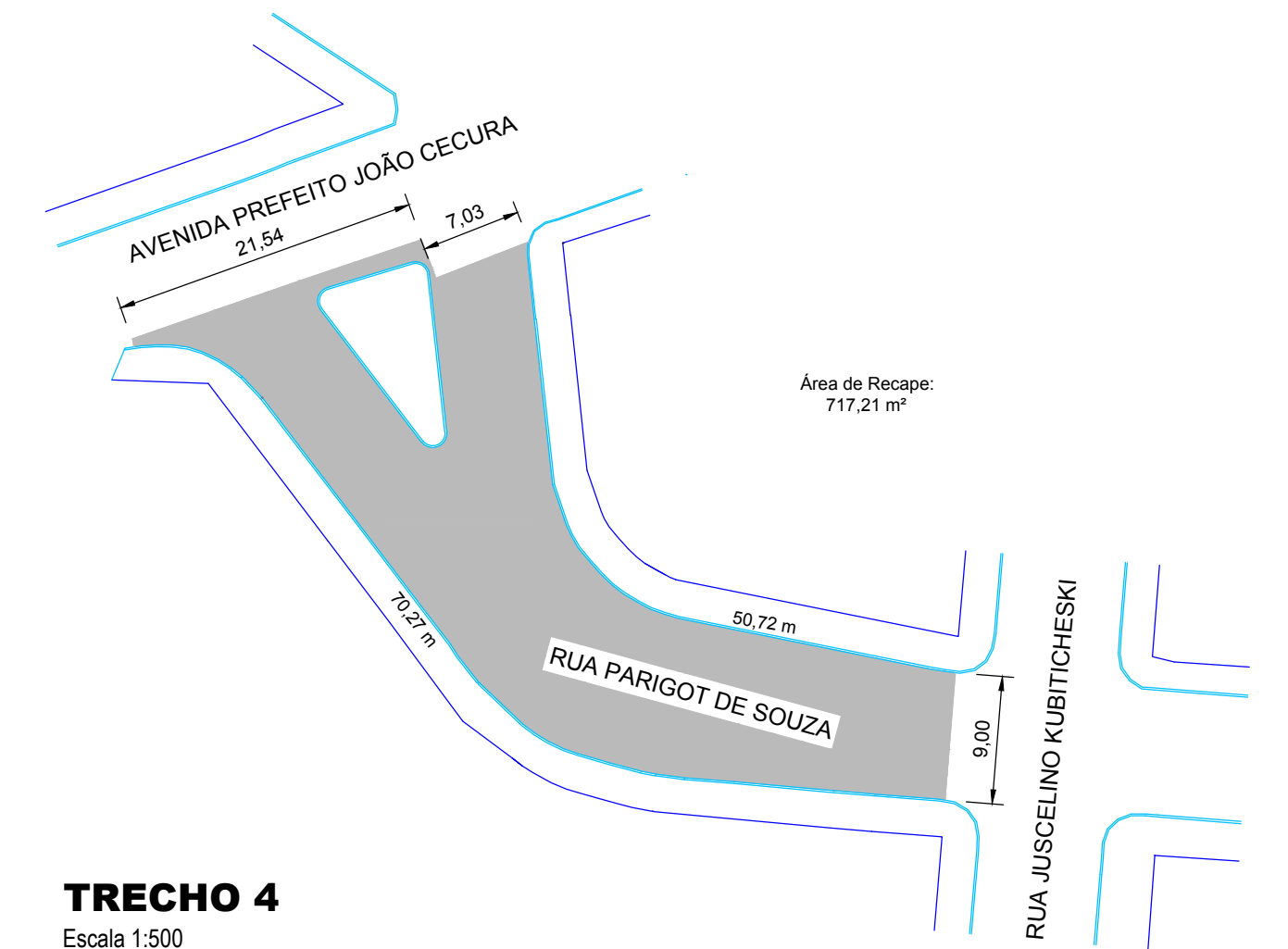

TRECHO 4
Escala 1:500

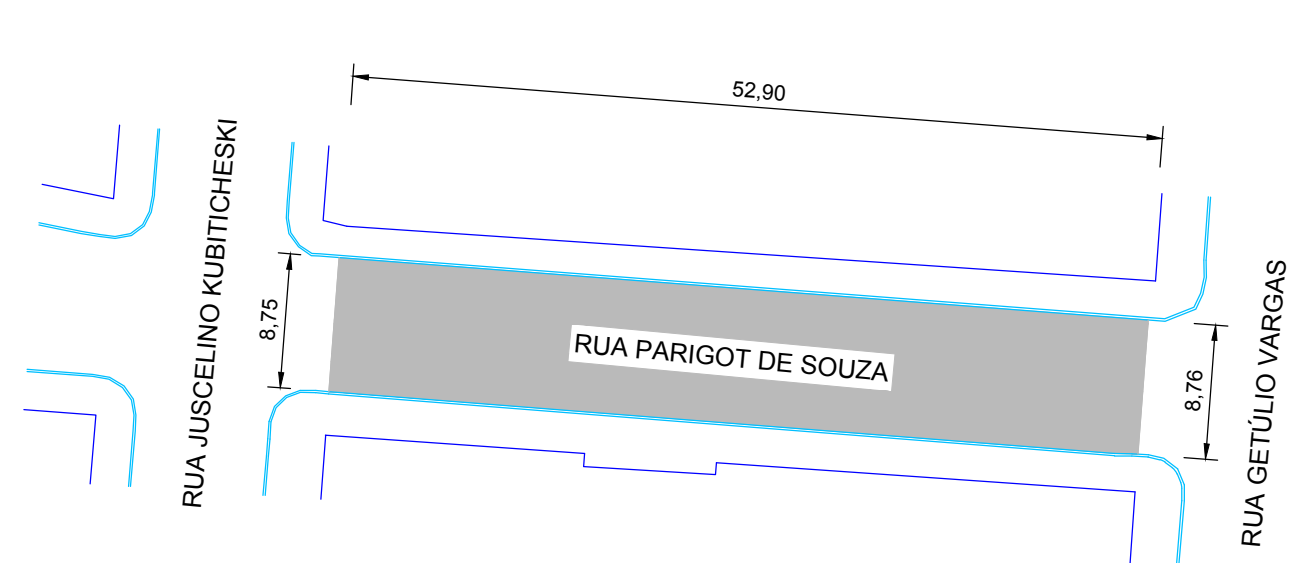

TRECHO 5
Escala 1:500

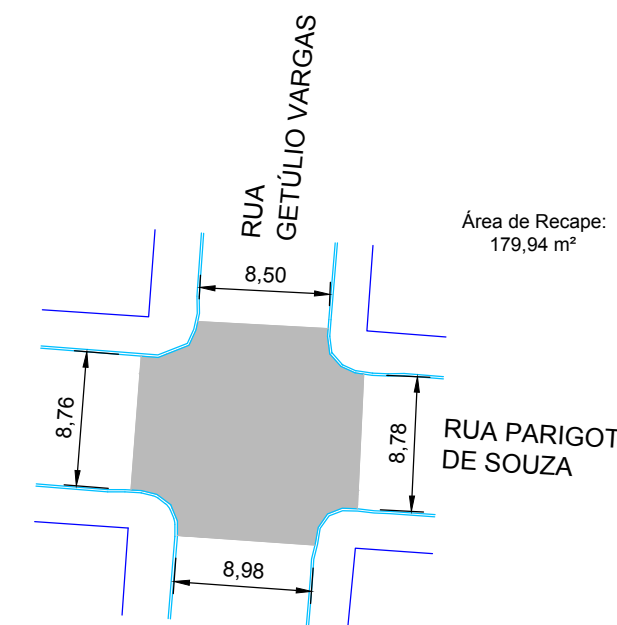

CRUZAMENTO 3
Escala 1:500

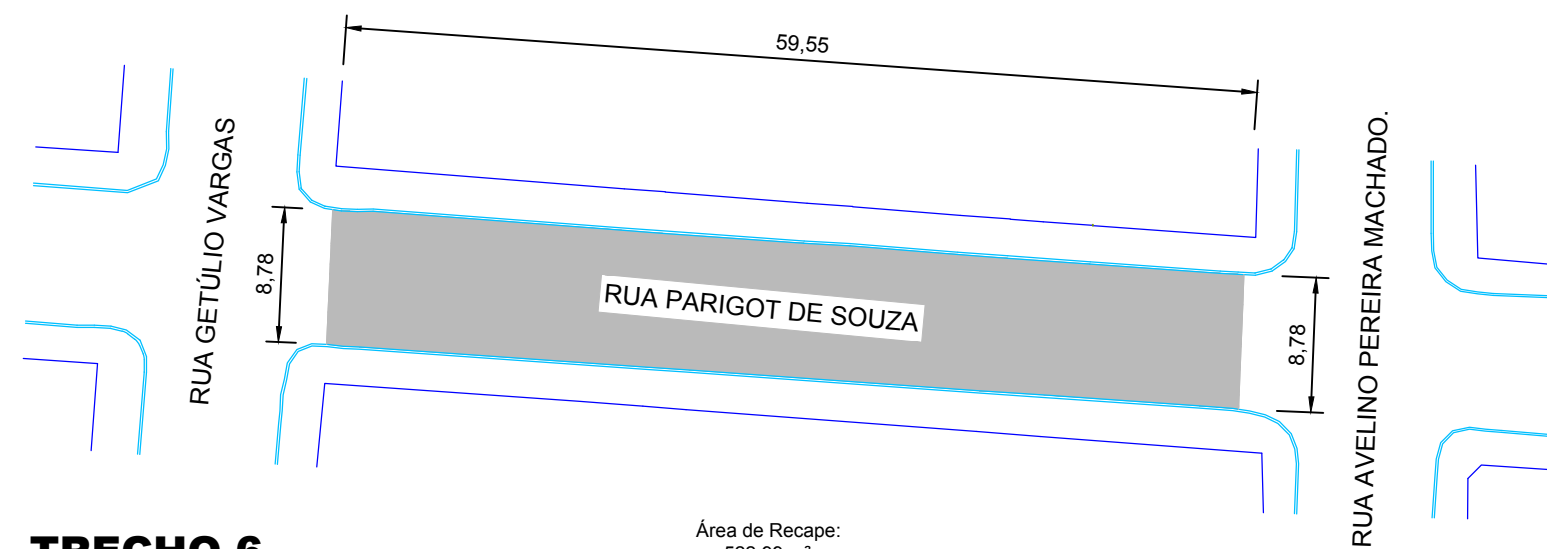

TRECHO 6
Escala 1:500

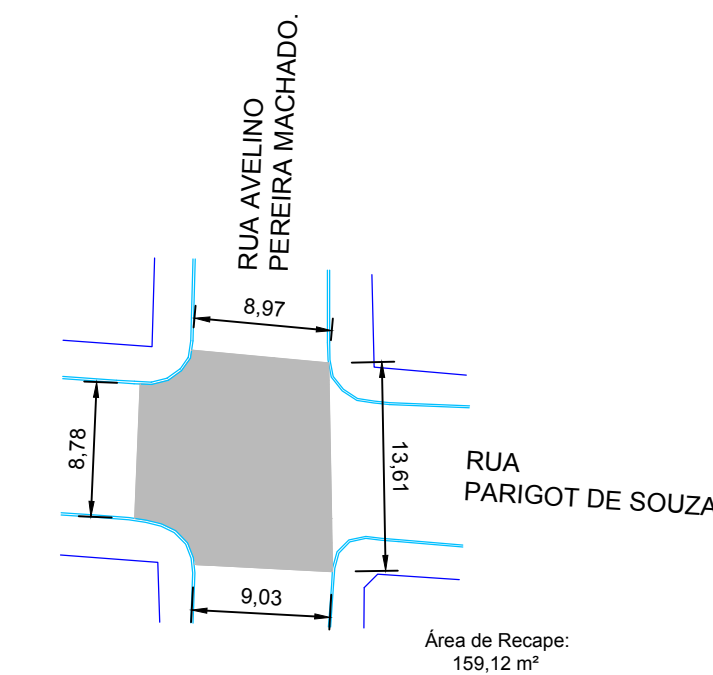

CRUZAMENTO 4
Escala 1:500

PREFEITURA MUNICIPAL DE PALMITAL

DEPARTAMENTO DE ENGENHARIA

PRANCHA
22/28

PROJETO DE PAVIMENTAÇÃO E PASSEIOS

ENDEREÇO DA OBRA:
Rua Parigot de Souza, Rua Juscelino Kubitschek, Rua 7 de Setembro, Rua Marechal Floriano Peixoto



CONTEÚDO:
Recapamento Asfáltico (Prancha 1 de 2)

PROPRIETÁRIO:
Prefeito **Valdenei de Souza**
Prefeitura Municipal de Palmital
CNPJ: 75.680.025/0001-82

RESPONSÁVEL TÉCNICO PELO PROJETO:
Eduardo O. Tomen
Engenheiro Civil - CREA-PR 80402/D

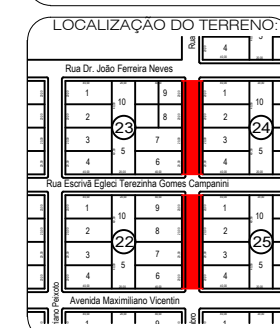

ESTATÍSTICAS:

AUTENTICAÇÕES:

DESENHO: Eduardo T.

ESCALA: Indicada

Palmital, 08 de Maio de 2019.